



**RAMCO**  
**TILE**  
**GROUT**  
CEMENT POLYMER GROUT

Ramco Tile Grout is a top-notch cement-based, polymer-modified mortar for filling tile joints. It's made with Portland cement or white cement, polymers and fillers for strong binding and excellent water resistance.

Ramco Tile Grout is a one component, pre-packed tile grout combining cement with selected pigment and several admixtures.



## Features

**Joint Filling:** It fills spaces between tiles, preventing the accumulation of dirt and moisture. This guards against potential damage over time.

**Expansion and Contraction:** Accommodates tile expansion and contraction during temperature changes, preventing cracks caused by thermal stress.

**Aesthetic Enhancement:** The color of grout significantly influences the overall appearance of a tiled surface. It can either complement or contrast with the tile color, impacting the visual design.

**Color Consistency:** Advanced formulations enhance color consistency, maintaining a uniform look throughout the installation for a polished and cohesive design.

**Flexibility:** Offers improved flexibility, adapting to slight movements without cracking, ensuring long-lasting durability.

**Ease of Application:** It is user-friendly, featuring a smoother consistency and easier mixing. This simplifies the application process, resulting in professional-looking installations.

## Advantages

Available in different colors

Easy to apply

Non-shrinking

Easy Maintenance

Non-cracking and No Powdering

Weather Resistant

Water Resistant

Abrasion Resistant

High Adhesion Strength



**RAMCO**  
**TILE**  
**GROUT**  
CEMENT POLYMER GROUT



## Directions for use

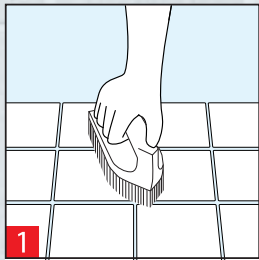

1 Prepare the Surface

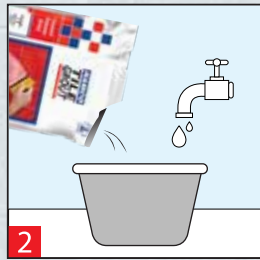

2 Mix 1Kg of Ramco Tile Grout with 3.2 - 3.5 litres of water

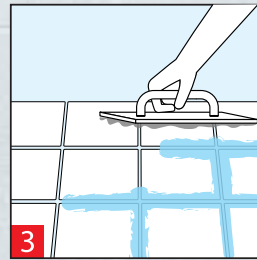

3 Fill the joints

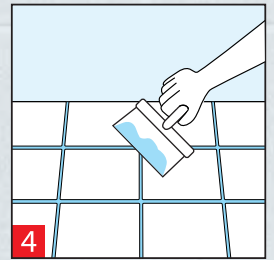

4 Remove excess Tile Grout

## Technical Specifications

Appearance (by visual observation) for Ramco Bright White Tile Grout	White colour powder
Water to Powder ratio (as per the required workable consistency)	32 - 34%
Pot Life (internal)	60 Minutes
Shrinkage in mm at 28 Day (air curing)	Zero
Swell in mm at 29 Day (air curing)	Zero
Bond Strength / Adhesion Strength at 29 Day (MPa)	1.4 - 1.5
Whiteness test by Spectrophotometer analysis	96.23 - 100%

## Other products from Ramco Dry Mix Division



Plastering



Plastering  
(Self-curing)



Tile Fixing

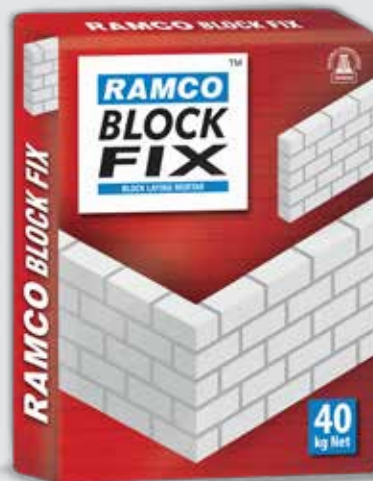

Block Mortar



Wall Putty

# RAMCO CEMENT

[www.ramcocements.in](http://www.ramcocements.in)