

RAMCO
SUPER
GROUT
CEMENTITIOUS

Ramco Super Grout

Ramco Super Grout is a cement based, high strength non-shrink structural grout to fill gaps or voids, reinforce structures and provide structural support in construction and engineering projects. It is typically composed of cement, fine aggregates and specialized polymers and additives. Commonly used for anchoring bolts in foundations, machinery foundations, base plates, etc.

Key Benefits

Ease of Use: Simple mixing and hassle-free application.

High Early Strength: Achieves rapid strength for fast-paced projects.

Excellent Flowability: Fills voids and reaches hard spaces with ease.

Enhanced Durability: Offers long-lasting structural support.

Oil & Water Resistance: Protects in challenging conditions.

Low Porosity: Minimizes water ingress for extended lifespan.



Application Areas

- Heavy machineries & equipment foundation
- Bridge bearing pad grouting & structural columns in pre-cast crane rail construction grouting
- Boiler foundation
- Turbine generator bearing plates
- Windmill foundation grouting.

Mixing Instructions

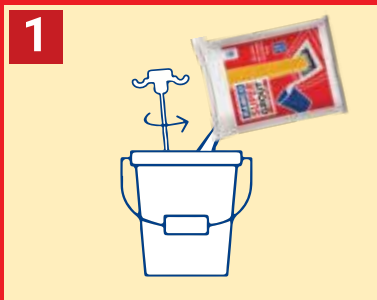

Add **15-16%** water by weight of Ramco Super Grout - Cementitious.

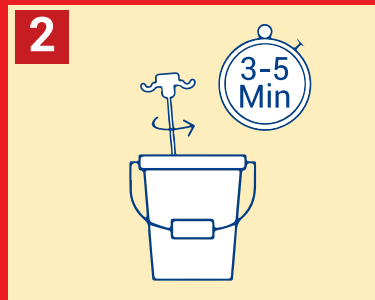

Mix thoroughly for **3-5 minutes** to form a smooth, workable paste.



Use the mixed grout within **20 minutes** for optimal results.





Application Guidelines

- **Surface Preparation:** Clean the surface to remove loose material. Then clean with water and remove excess water on the surface with cloth / sponge. Wait for few minutes till the surface shows signs of drying (SSD condition).
- **Shuttering:** Ensure water-tight shuttering to prevent slurry loss.
- **Grout Placement:** Pour directly, maintaining grout head throughout. Troweling is not required .
- **Air Bubble Removal:** Gently rod the grout to eliminate air bubbles.
- **Edge Rounding:** Sharp edges, if any, should be rounded off.
- **Curing:** Water curing after 12 hours of application for 3 days.

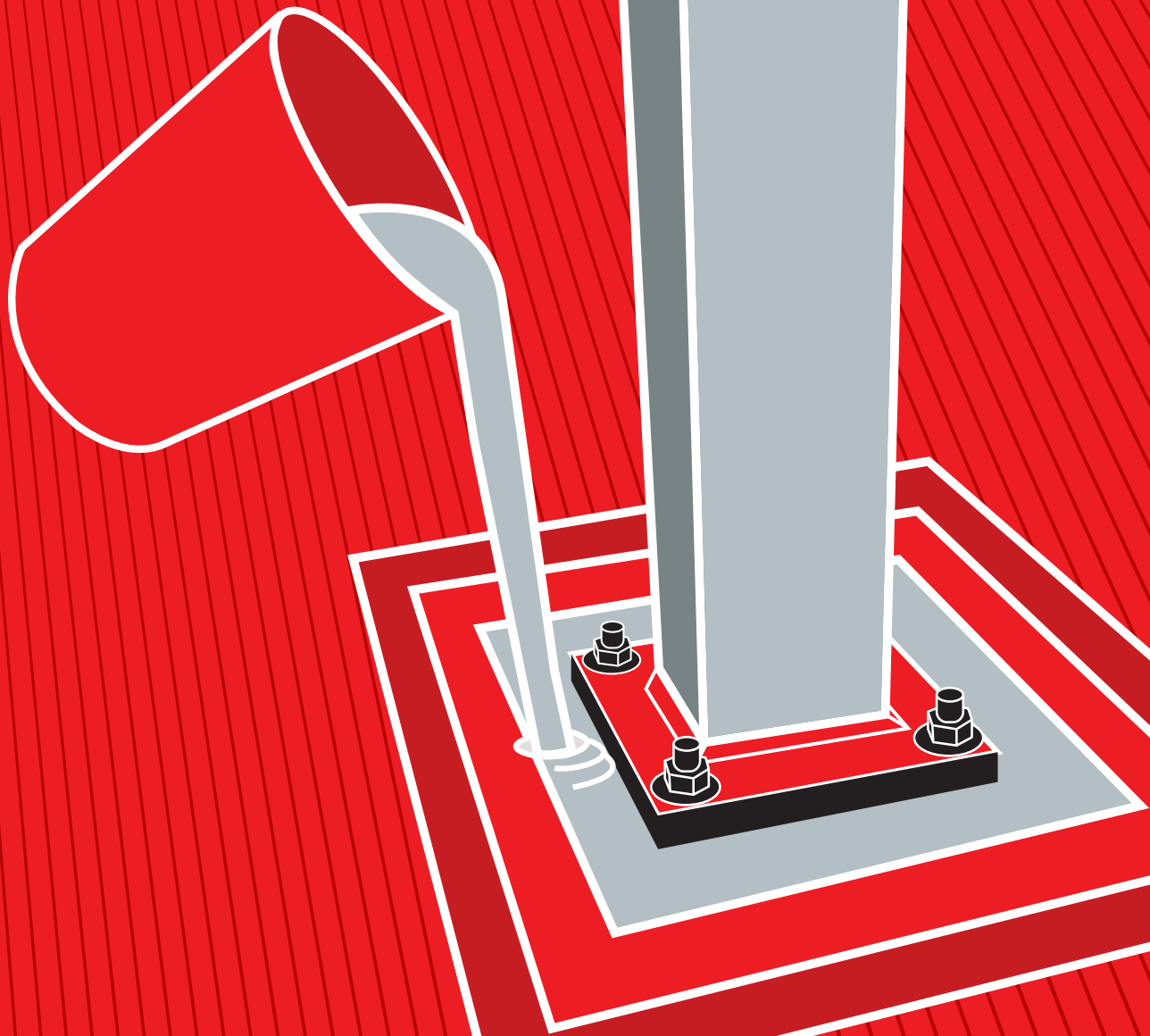

Curing Instructions

Water curing for 3 days is recommended immediately after 12 hours of application.

Technical Specifications

Physical Properties	Standards	Typical Values
Colour	-	Grey Colour
Dry Density	Lab Developed Method	1200 - 1300 Kg/m ³
Percentage of water to be added by weight	-	15-16%
Yield	-	13 to 14 litres when 25 kg grout is mixed with 15 to 16% water
Flow with the prescribed water percentage	Lab Developed Method	240-260 mm
Modulus of Elasticity	ASTM C-469-02e1	32490 N/mm ²
Shrinkage %	-	Compensated
Initial Setting Time	IS 4031 Part 5	145 minutes
Final Setting Time		450 Minutes
Flexural Strength @ 28 days	ASTM C-580-18 (2018)	40-45 N/mm ²
Tensile Strength	-	20 to 22 N/sq.m.
Compressive Strength details		
3 Day	ASTM C-109-21	45-50 N/mm ²
7 Day		65-70 N/mm ²
28 Day		85-90 N/mm ²

Storage instructions: Store in a covered, dry and moisture-free place.

Right Products **for** Right Applications

